

Oil Coolers

Setrab Oil Coolers

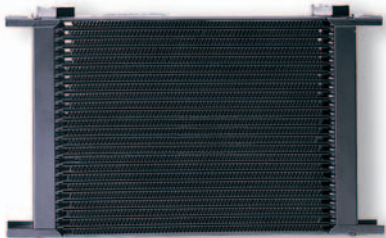

Proline Oil Coolers

Design: Connections are available in a number of BSP, Metric and JIC dimensions. Fins and Turbulators are available in a number of different designs. The coolers are delivered as standard with brackets in accordance with the dimension sketch.

Efficiency: The cooler is built up of shallow tubes having internal turbulators and external fins. The special method of manufacture involves the full brazing of all inner and outer contact surfaces which results in a highly efficient heat exchanger.

Module System: The unique module system covers over 600 different sizes. The program comprises coolers in 9 different lengths from 210 to 405mm. The coolers can have from 5 to 72 fin rows which means 36 to 565mm in height. There is always a wide range of coolers in stock, available for immediate delivery.

Production: The method of manufacture is designed to produce everything from individual coolers to large series. This makes it possible to have short delivery times without set-up costs. Production standards are in accordance with ISO 9000 BS5750.

- Available with the following Male or Female Threads:
- Metric, BSP, JIC, UNF or AN. Please state when ordering

Type	A (Total Width)	B (Matrix Width)	C (Centre Distance Between Connections)	D (Centre Distance Between Fixing Holes)
1	210	163	130	190
2	230	183	150	210
3	255	208	175	235
4	280	233	200	260
5	305	258	225	285
6	330	283	250	310
7	355	308	275	335
8	380	333	300	360
9	405	358	325	385





Alternative Setrab oil cooler configurations.

Type	Depth D mm	Length L mm	Height H mm
<i>STD, Air-cooled oil cooler</i>			
107	50	210	52
110	50	210	75
113	50	210	99
116	50	210	123
119	50	210	146
125	50	210	194
150	50	210	391
607	50	330	52
610	50	330	75
613	50	330	99
616	50	330	123
619	50	330	146
625	50	330	194
634	50	330	265
640	50	330	312
910	50	405	75
915	50	405	115
919	50	405	146
925	50	405	194

<i>CP, Air-cooled oil cooler with built-in fan</i>			
CP 119	170	220	154
CP 224	128	260	193
CP 920	153	407	165

<i>TOC, Water-cooled oil cooler</i>			
TOC 150	Ø 85	252	
TOC 200	Ø 85	305	
TOC 250	Ø 85	352	
TOC 300	Ø 85	402	
TOC 350	Ø 85	452	

<i>SLM, Air-cooled oil cooler (only with M18 female)</i>			
SLM 420-6	40	484	61
SLM 420-14	40	491	133

<i>COM, Air-cooled oil cooler</i>			
500 COMF-10	50	568	123
500 COMF-15	50	568	187
500 COMF-20	50	568	252
500 COMF-25	50	568	316

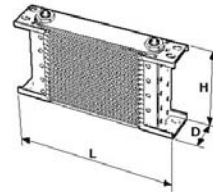

STD

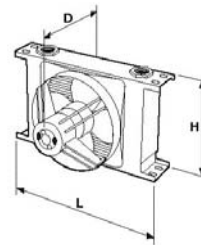

CP

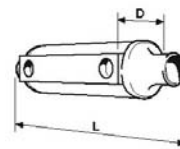

TOC

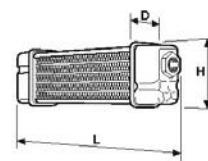

SLM

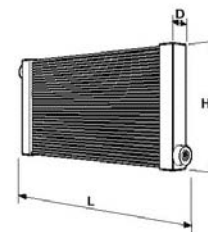

COM